

54+35⁸⁵ ⊙ Set Hub C of 32nd St produced

54+76 ⊙ E + W fence, Sean Woodmaness orchard

55+00 ⊙ Set Hub

A. F. PARKER

60+03.2 Enter Woodmaness apple orchard
then worked on effect)

from Center line produced

(Note: as far as Sta 60 to 32 taken

43.2 west of C of Adams + 30 that

61+94⁸⁵ ⊙ Just over effect Hub B.S. on Hub

lines in orchard S of 31st Street

43.2 for effect to avoid row of

hence 90⁰⁰ set + west set hub

61+94⁸⁵ ⊙ Just over Hubs B.S. on Hub 69+53⁸⁵

See pages 11-13 this book

For Transit notes from 31st St Hub 78

from 31st Street South
are South of 2nd Street

B 36

I was for the opening of Adams
Saturday Am. Oct 1 1889

32nd St 306.0

ETW FENCE

Sta 54+35⁸⁵

x Sta 54+76

A. F. PARKER

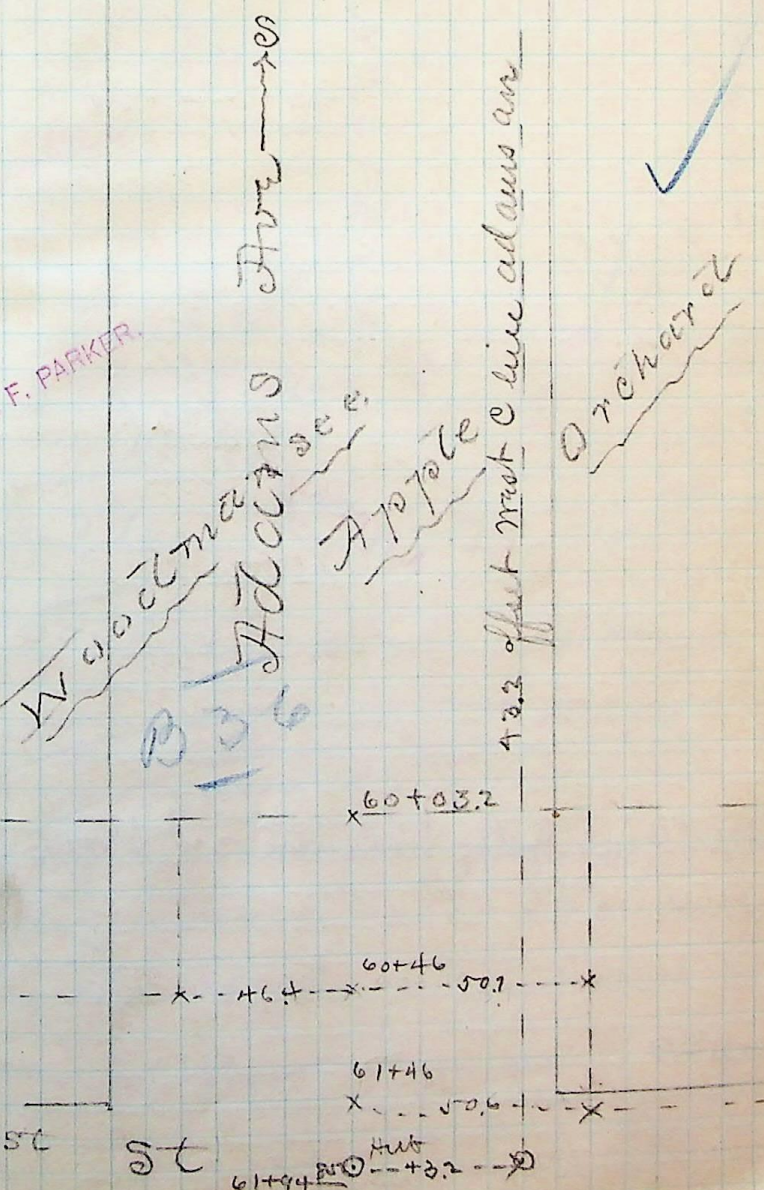

31st St

61+94 Hub
61+94⁸⁵ ⊙ ---+3.2--- ⊙